

## INSTALLATION INSTRUCTIONS

# CONNEX

## LED UNDER CABINET STRIP LIGHT

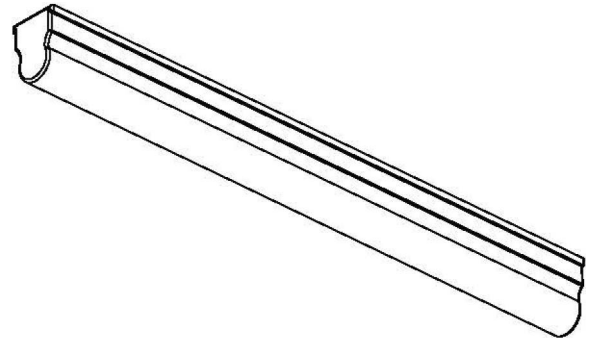

CODE: 2004 / 2008 / 2012 / 2016

**IMPORTANT :** please read these instructions before commencing installation and retain for future reference

### Components

### Tools required

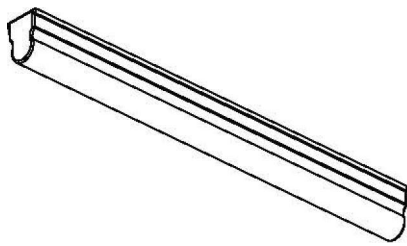

1 x Under Cabinet Strip light

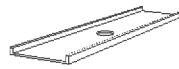

2 x Fixing  
Brackets



2 x Screws



1 x Fitting Instructions

Pencil



PZ1 Screw Bit

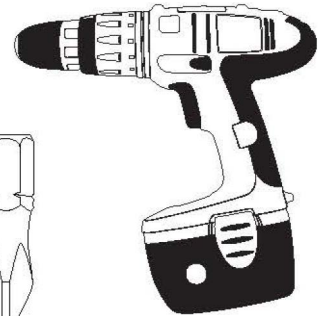

Power Drill

### Important safety information

Please read these instructions carefully before attempting to install this product. It is advisable to keep these instructions in a safe place for further reference.

We recommend that you consult a qualified electrician. All electrical installations must be carried out in accordance with current IEE wiring regulations (BS7671).

These products must not be modified, if any modifications are made, it may invalidate the warranty and may render the product unsafe. This product is mains powered.

- If in doubt installation must be carried out by a qualified electrician.
- Install on smooth flat surface(s) only.
- The wattages of this product are as follows:
  - 2004 = 4W
  - 2008 = 8W
  - 2012 = 12W
  - 2016 = 16W

### Safety instructions

1. Before commencing installation or maintenance, isolate the main electrical supply for the appropriate circuit at the fuse board.
2. The light should be mounted onto a secure surface.
3. Position lights where they will not be exposed to steam or splashes etc.
4. Suitable for furniture lighting.
5. When the lamp expires the fitting must be replaced.
6. Class III safety extra low voltage (SELV).



# LED UNDER CABINET STRIP LIGHT

## Installation

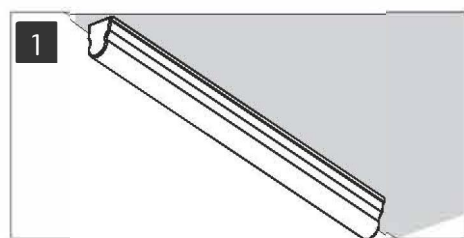

Mark the desired position for your light under the cabinet.

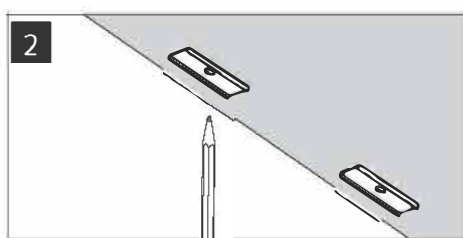

Using a pencil, mark where the fixing brackets will be placed - one at either end to take the weight of the light evenly.

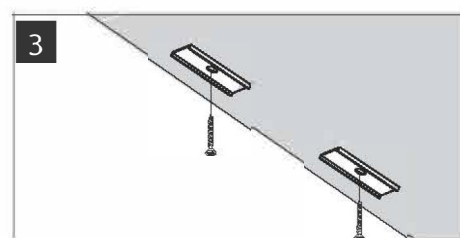

Fix the brackets to the desired position using screws.

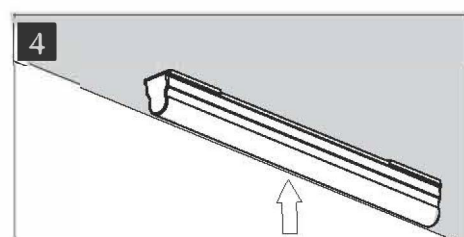

Clip the connex light into the two brackets.

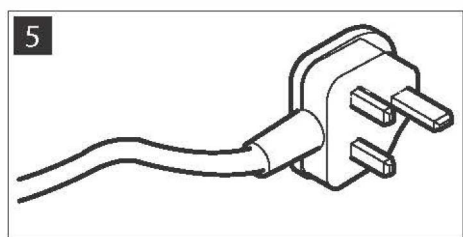

Finally connect directly to 240V mains supply or 13A plug top.

## Operation

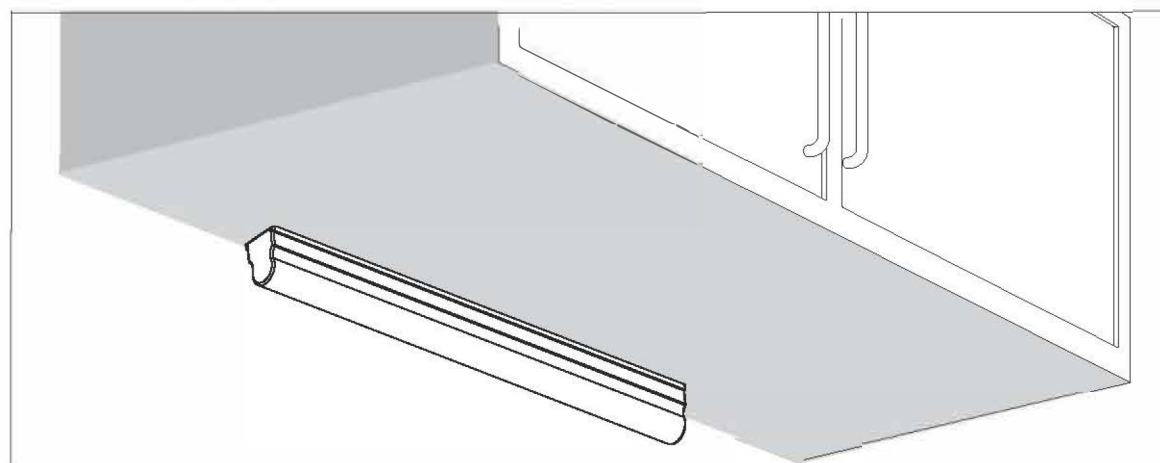

The Connex strip under cabinet light is connected to the mains. Place many lights in a row for longer kitchen cabinets.

## Maintenance & Care

- Ensure that the power is disconnected prior to cleaning.
- To keep the finish of this product, wipe over with soft cloth periodically.
- Do not use harsh chemical solvents, it may dis-colour or damage the finish.